

REV A - 9/20/16 - RLF - ADDED THINNED SECTION
 REV B - 2/8/18 - ADDED RECESS AND THRU HOLE, CHANGED LENGTH TO 24"
 REV C - 10/2/18 - RAL - UPDATED WEIGHT
 REV D - 6/1/2021 - JCG - UPDATED WEIGHT AND NOTES
 REV E - 8/11/2021 - JCG - CHANGED FROM INSERTS TO LIFTING SLOTS, UPDATED WEIGHT, UPDATED DRAFT

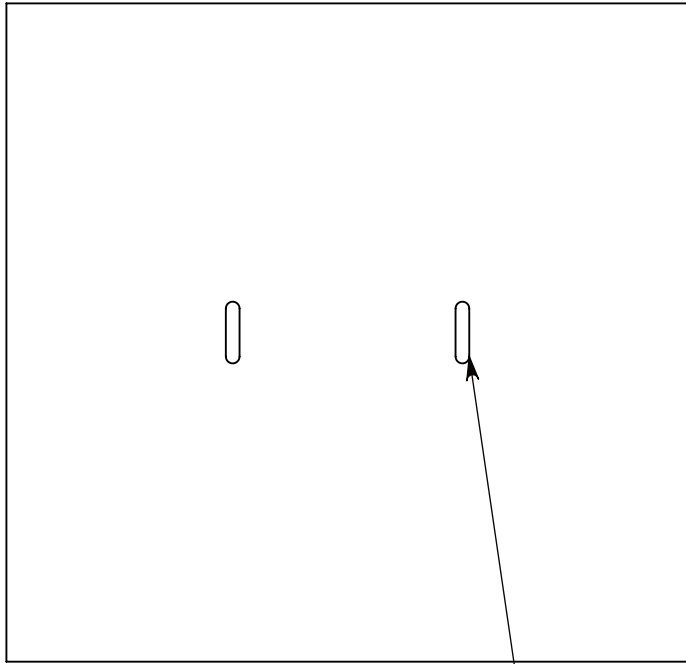

LIFTING SLOT (2X)

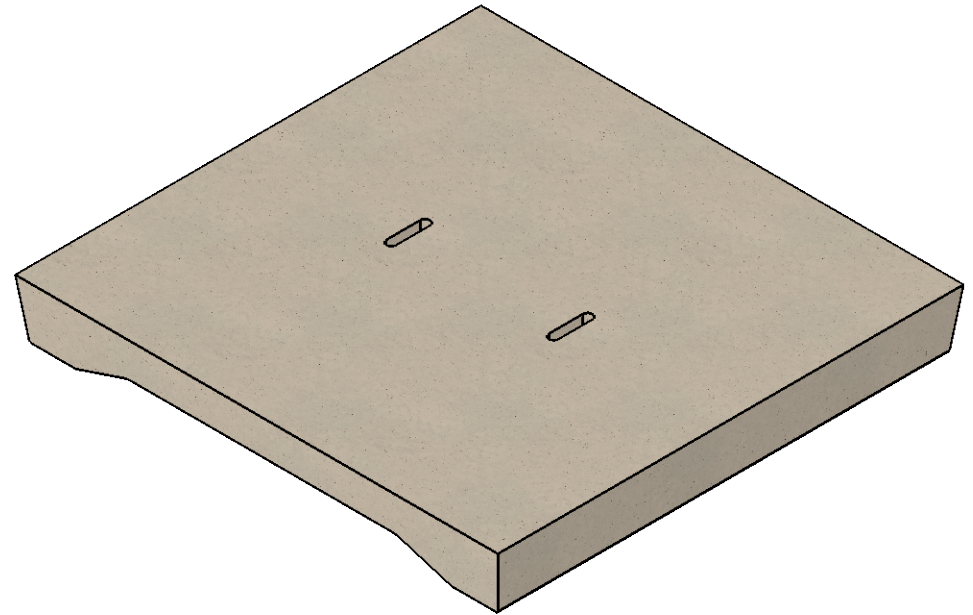

COVER ASSEMBLES ONTO 20" INSIDE WIDTH
 HEAVY TRAFFIC RATED CONCAST HT3 CHANNEL

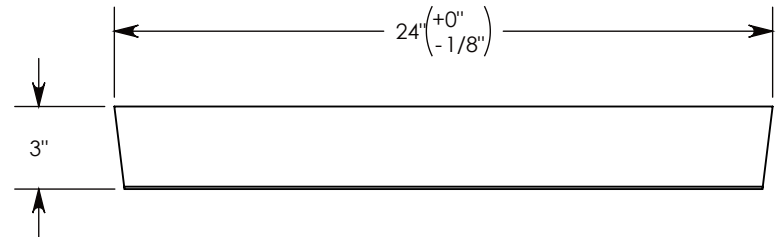
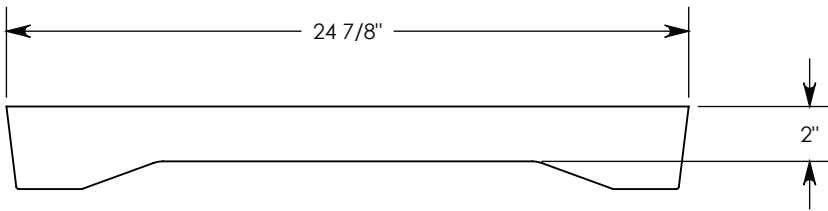

NOTE 1: FOR NON-STANDARD LENGTHS, THE PART NUMBER WILL CORRESPOND TO IT'S MEASURED LENGTH. IE: 8021HT3P 18"

AASHTO H-20 RATED – 32,000 LB. SINGLE AXLE LOAD

DRAWN BY: JESSE GUTTING		 1010 NORTH STAR DRIVE P.O. BOX 69 ZUMBROTA, MN 55992-0069	DESCRIPTION: HEAVY TRAFFIC POLYMER COVER		SHEET 1 OF 1
CREATED DATE: 8/22/2002	REVISION LEVEL: E		DIMENSIONS ARE IN INCHES		
SAVED DATE: 8/11/2021	SAVED BY: jgutting		TOLERANCES: FRACTIONAL: ± 1/8" ANGULAR: ± 2°		
WEIGHT: 98 LBS.	MATERIAL: POLYMER		CONTACT INFORMATION: EMAIL: INFO@CONCASTINC.COM PHONE: (507) 732-4095 FAX: (507) 732-4094		
			PART NUMBER: 8021HT3P		