

REV A - 2/8/18 - RAL - ADDED RECESS AND THRU HOLE, CHANGED LENGTH TO 23.125"

REV B - 10/2/18 - RAL - UPDATED WEIGHT

REV C - 8/20/2021 - JCG - REMOVED INSERTS, ADDED LIFTING SLOTS

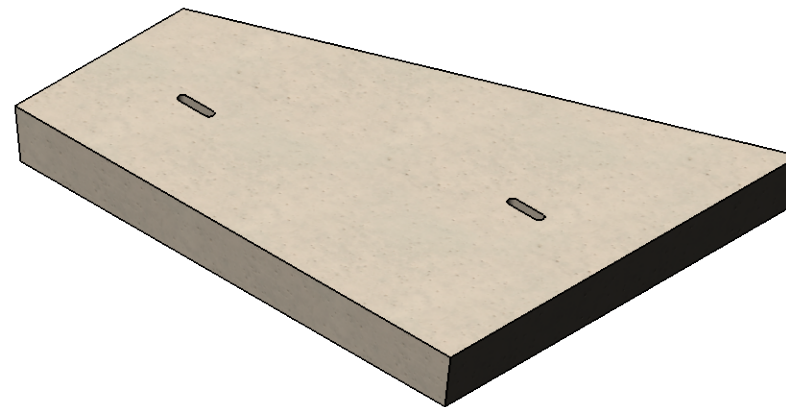
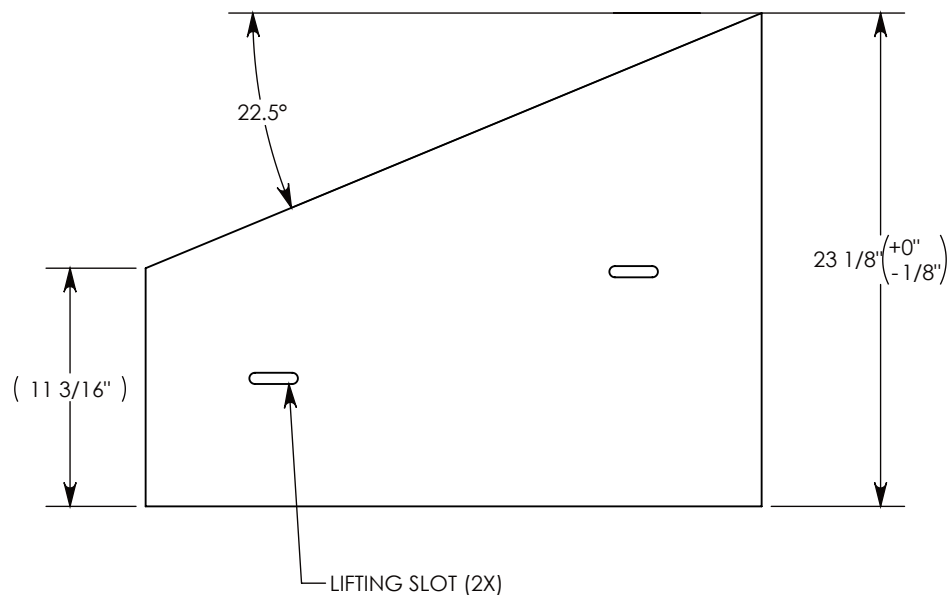

COVER ASSEMBLES ONTO 24" INSIDE WIDTH
HEAVY TRAFFIC RATED CONCAST HT3 CHANNEL

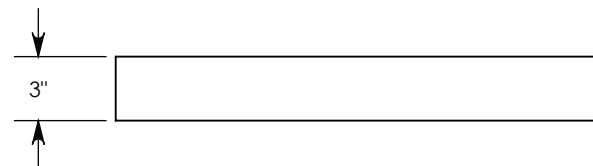
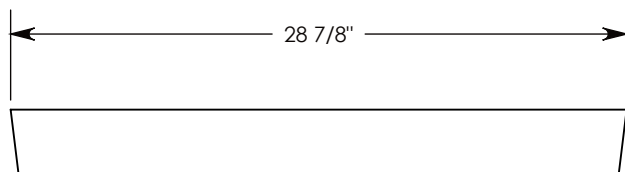

AASHTO H-20 RATED – 32,000 LB. SINGLE AXLE LOAD

DRAWN BY: **JESSE GUTTING**

CREATED DATE: **8/22/2002** REVISION LEVEL: **C**

SAVED DATE: **8/20/2021** SAVED BY: **jgutting**

WEIGHT: **105 LBS.** MATERIAL: **POLYMER**

CONCAST
1010 NORTH STAR DRIVE
P.O. BOX 69
ZUMBROTA, MN 55992-0069

DESCRIPTION:
HEAVY TRAFFIC COVER

DIMENSIONS ARE IN INCHES
TOLERANCES:
FRACTIONAL: $\pm 1/8 \text{''}$
ANGULAR: $\pm 2^\circ$

CONTACT INFORMATION:
EMAIL: INFO@CONCASTINC.COM
PHONE: (507) 732-4095
FAX: (507) 732-4094

SHEET 1 OF 1

PART NUMBER:
8025HT3P 22.5L