

REV.A - JCG - 12-19-2017 - INCREASED WIDTH AND INCREASED DRAFT
 REV.B - RAL - 5/17/2019 - ADDED COUNTERBORE FOR PLASTIC PLUG INSERTS

FIBERCRETE[®]
TRENCH
SYSTEM

STEEL REINFORCED CONCRETE

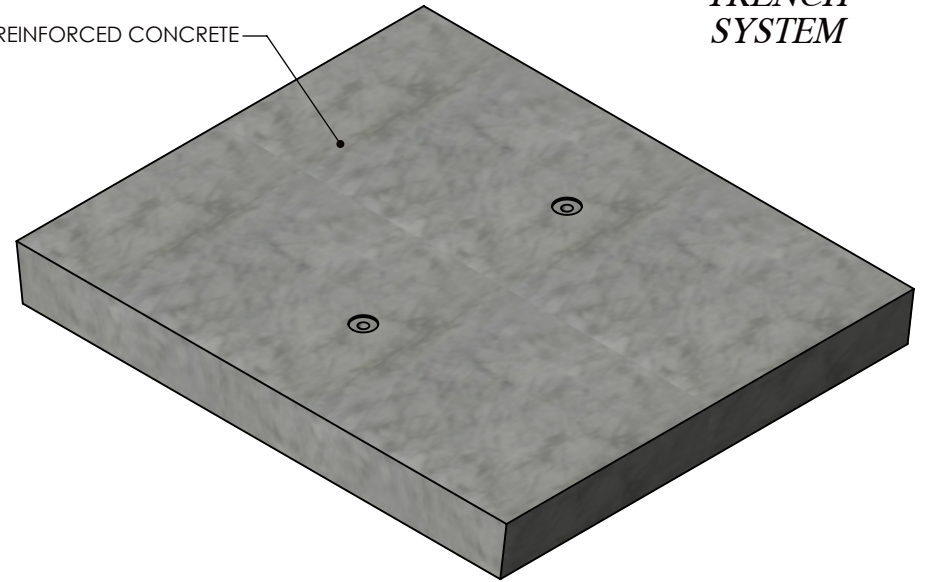

COVER ASSEMBLES ONTO 24" INSIDE WIDTH
 HEAVY TRAFFIC RATED CONCAST HT3 CHANNEL.

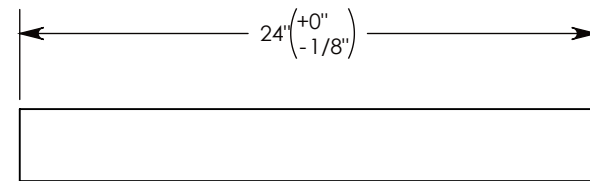
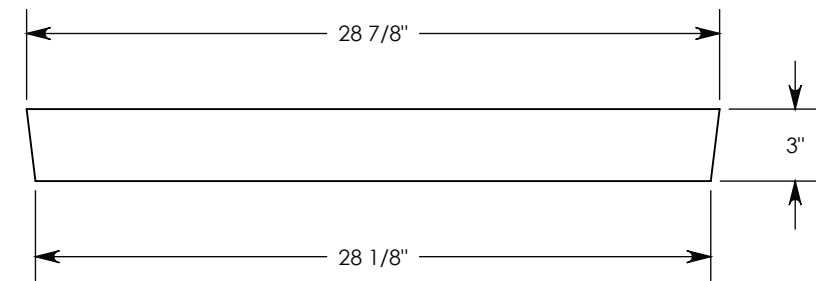
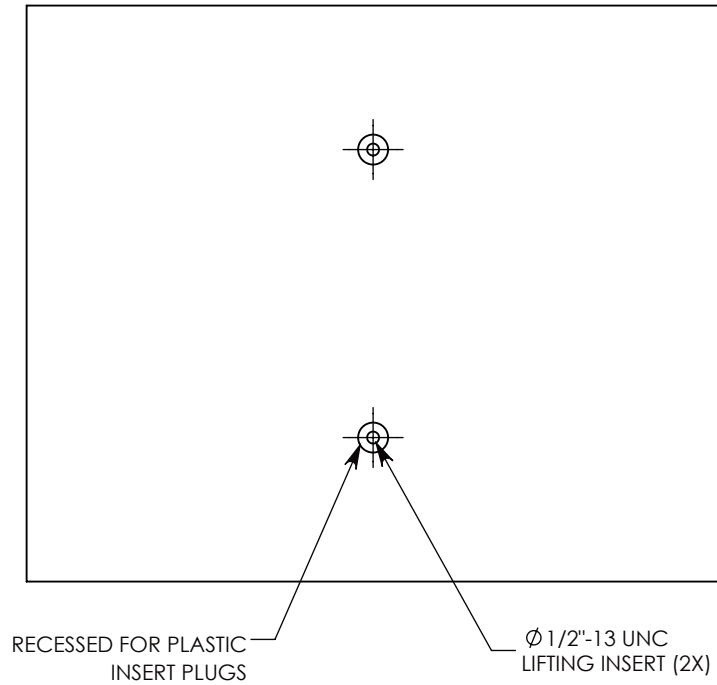

AASHTO H-20 RATED – 32,000 LB. SINGLE AXLE LOAD

DRAWN BY: ROBIN FLINT

DATE: 5/17/2019

REVISION LEVEL: B

WEIGHT:

168 LBS.

MATERIAL:

CONCRETE

CONCAST
 1010 NORTH STAR DRIVE
 P.O. BOX 69
 ZUMBROTA, MN 55992-0069

DESCRIPTION:

HEAVY TRAFFIC COVER

DIMENSIONS ARE IN INCHES
 TOLERANCES:
 FRACTIONAL: ± 1/8"
 ANGULAR: ± 2°

CONTACT INFORMATION:
 EMAIL: INFO@CONCASTINC.COM
 PHONE: (507) 732-4095
 FAX: (507) 732-4094

SHEET 1 OF 1

PART NUMBER:

8025HT3 24"