

REV A- 9/20/16 - RLF - ADDED THINNED SECTION
 REV B- 2/8/18 - RAL - ADDED RECESS AND THRU HOLE, CHANGED LENGTH TO 24"
 REV C- 10/2/18 - RAL - UPDATED WEIGHT
 REV D - 8/11/2021 - JCG - CHANGED FROM INSERTS TO LIFTING SLOTS, UPDATED WEIGHT, UPDATED DRAFT

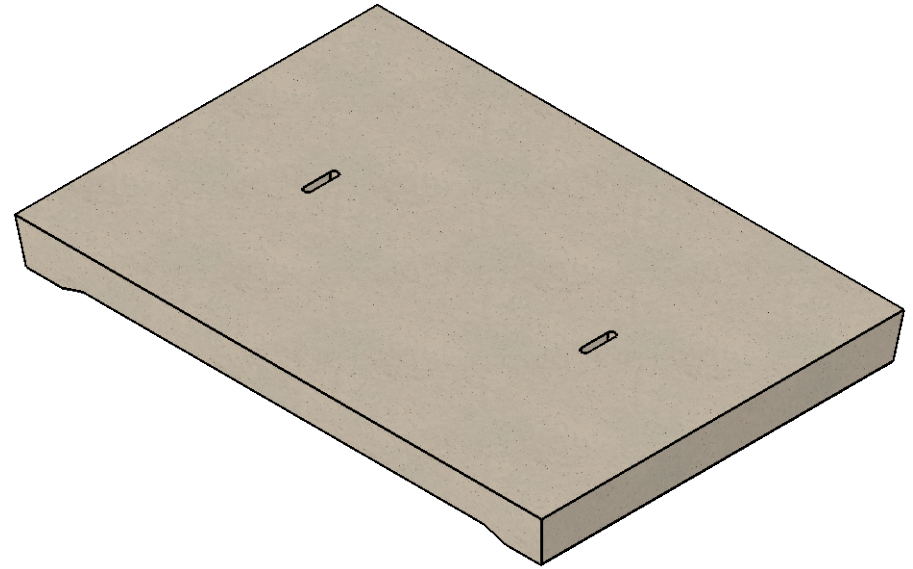

COVER ASSEMBLES ONTO 30" INSIDE WIDTH
 HEAVY TRAFFIC RATED CONCAST HT3 CHANNEL

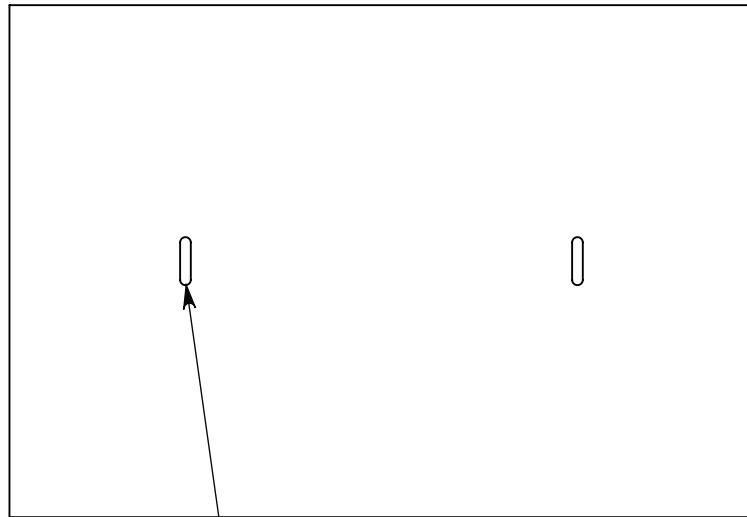

LIFTING SLOT (2X)

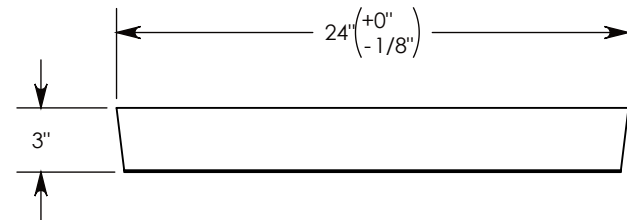
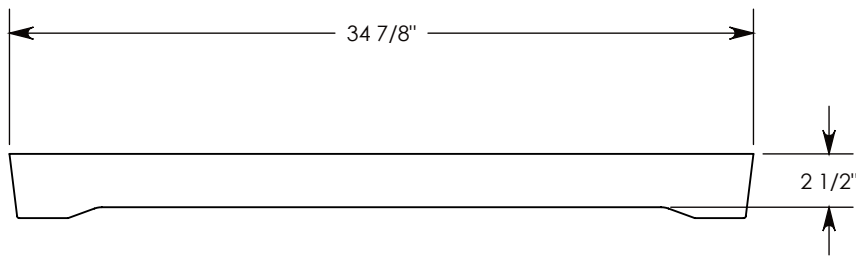

NOTE 1: FOR NON-STANDARD LENGTHS, THE PART NUMBER WILL CORRESPOND TO IT'S MEASURED LENGTH. IE: 8031HT3P 18"

AASHTO H-20 RATED – 32,000 LB. SINGLE AXLE LOAD

DRAWN BY: JESSE GUTTING	
CREATED DATE: 8/22/2002	REVISION LEVEL: D
SAVED DATE: 8/11/2021	SAVED BY: jgutting
WEIGHT: 153 LBS.	MATERIAL: POLYMER



1010 NORTH STAR DRIVE
 P.O. BOX 69
 ZUMBROTA, MN 55992-0069

DESCRIPTION: HEAVY TRAFFIC POLYMER COVER		SHEET 1 OF 1
DIMENSIONS ARE IN INCHES TOLERANCES: FRACTIONAL: ± 1/8" ANGULAR: ± 2°	CONTACT INFORMATION: EMAIL: INFO@CONCASTINC.COM PHONE: (507) 732-4095 FAX: (507) 732-4094	
PART NUMBER: 8031HT3P		