

FIBERCRETE[®]

FIBER REINFORCED CONCRETE

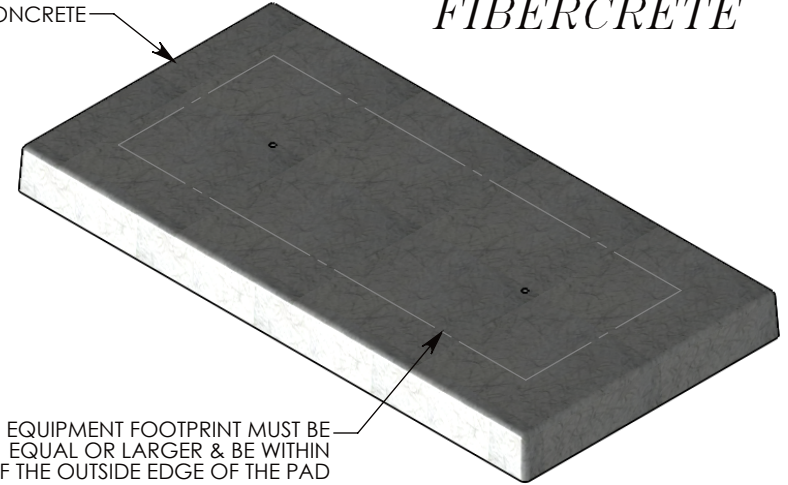

EQUIPMENT FOOTPRINT MUST BE EQUAL OR LARGER & BE WITHIN 5" OF THE OUTSIDE EDGE OF THE PAD

Ø 1/2"-13 UNC INSERT FOR LIFTING (2X) LOCATIONS MAY VARY

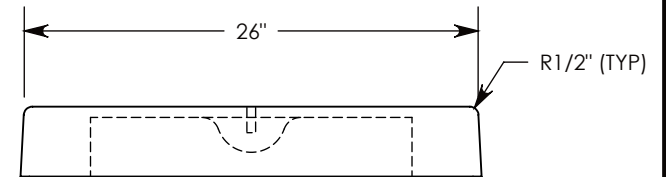
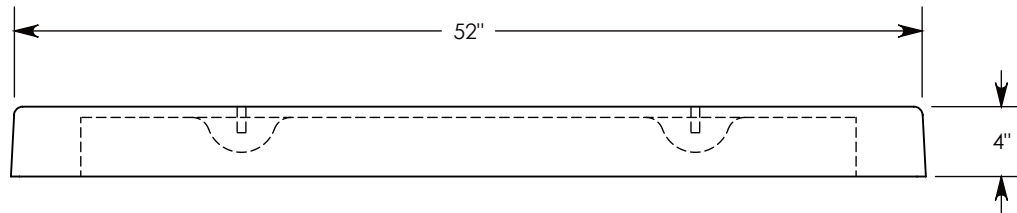
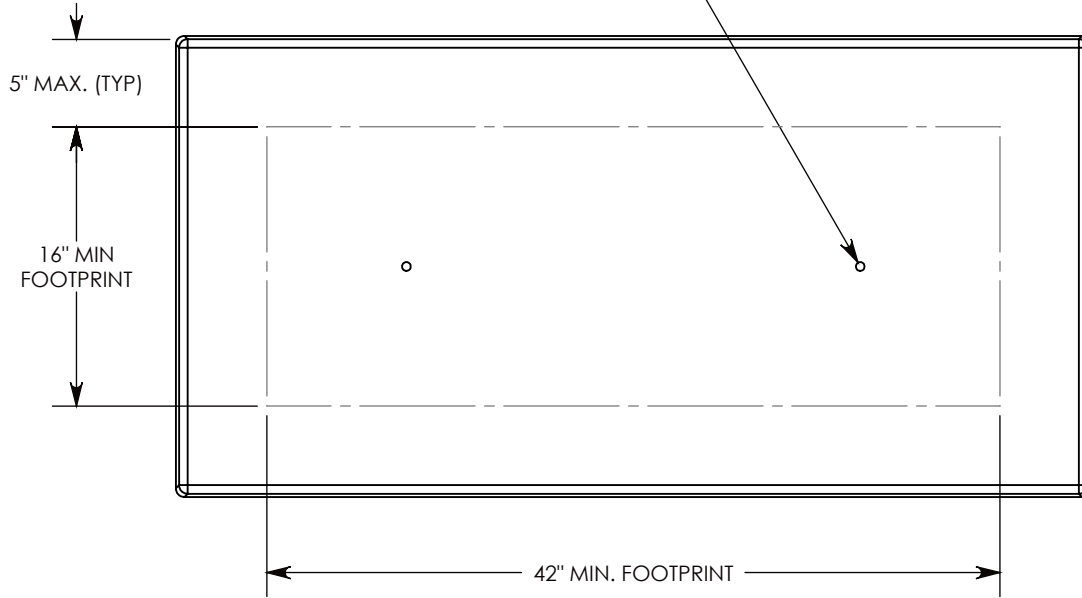

UNLESS OTHERWISE DIRECTED, THIS PAD IS SUPPLIED AS SHOWN WITH NO CABLE ROUTING OPENINGS. IF OPENINGS ARE REQUIRED, MARK-UP THIS DRAWING WITH THEIR LOCATIONS & SIZES. MOUNTING INSERTS ARE TO BE FIELD INSTALLED. CONCAST TOGGLE NUTS ARE IDEAL; SPECIFY QUANTITY AND SIZE (1/4", 3/8", OR 1/2") WHEN ORDERING.

DRAWN BY: ROBIN FLINT	
DATE: 7/7/2014	REVISION LEVEL: 0
WEIGHT: 125 LBS.	MATERIAL: FIBERCRETE FC



CONCAST
 1010 NORTH STAR DRIVE
 P.O. BOX 69
 ZUMBROTA, MN 55992-0069

DESCRIPTION:		
FIBERCRETE FLAT PAD		
DIMENSIONS ARE IN INCHES	CONTACT INFORMATION:	
TOLERANCES:	EMAIL: INFO@CONCASTINC.COM	
FRACTIONAL: ± 1/8"	PHONE: (507) 732-4095	
ANGULAR: ± 2°	FAX: (507) 732-4094	
PART NUMBER:		SHEET 1 OF 1
FC-26-52-4		