

FIBERCRETE®

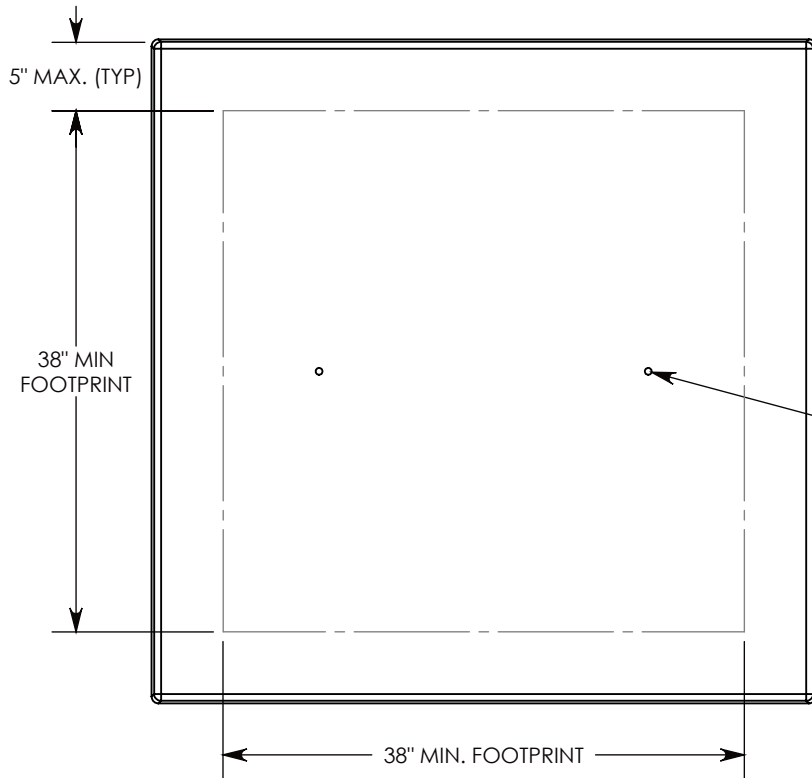

FIBER REINFORCED CONCRETE

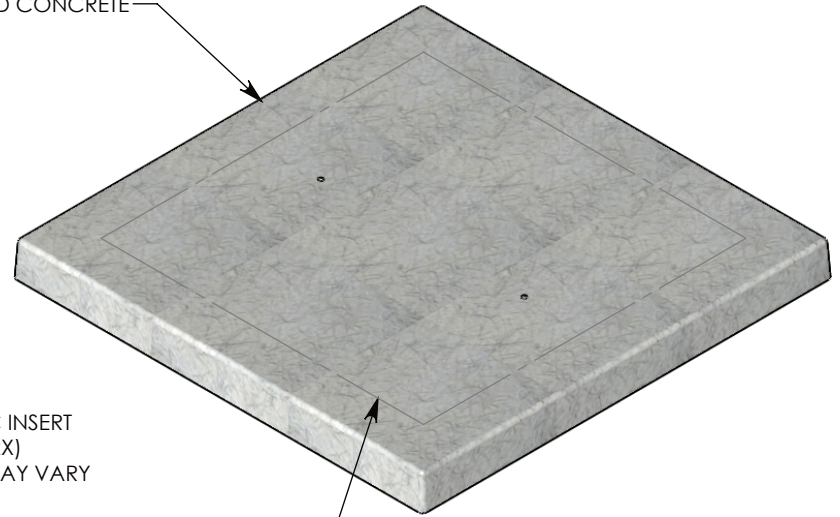

Ø 1/2"-13 UNC INSERT  
FOR LIFTING (2X)  
LOCATIONS MAY VARY

EQUIPMENT FOOTPRINT MUST BE  
EQUAL OR LARGER & BE WITHIN  
5" OF THE OUTSIDE EDGE OF THE PAD

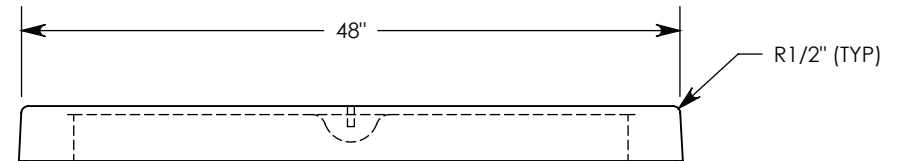
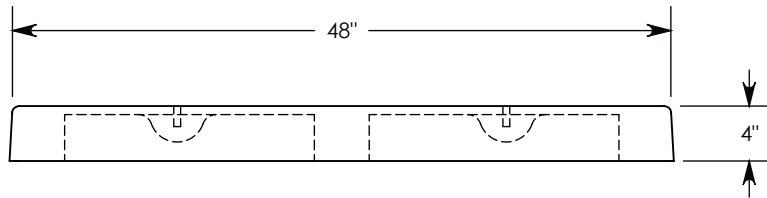

UNLESS OTHERWISE DIRECTED, THIS PAD IS SUPPLIED AS SHOWN WITH NO CABLE ROUTING OPENINGS.

**IF OPENINGS ARE REQUIRED, MARK-UP THIS DRAWING WITH THEIR LOCATIONS & SIZES.**

MOUNTING INSERTS ARE TO BE FIELD INSTALLED. CONCAST TOGGLE NUTS ARE IDEAL; SPECIFY QUANTITY AND SIZE (1/4", 3/8", OR 1/2") WHEN ORDERING.

**DRAWN BY: ROBIN FLINT**

**DATE: 5/1/2013**

**REVISION LEVEL: 0**

**WEIGHT:**

**204 LBS.**

**MATERIAL:**

**FIBERCRETE FC**



1010 NORTH STAR DRIVE  
P.O. BOX 69  
ZUMBROTA, MN 55992-0069

**DESCRIPTION:**

**FIBERCRETE FLAT PAD**

DIMENSIONS ARE IN INCHES  
TOLERANCES:  
FRACTIONAL: ± 1/8"  
ANGULAR: ± 2°

CONTACT INFORMATION:  
EMAIL: INFO@CONCASTINC.COM  
PHONE: (507) 732-4095  
FAX: (507) 732-4094

SHEET 1 OF 1

**PART NUMBER:**

**FC-48-48-4**