

REV C. - JCG - 2/6/2018 - ADDED CUTOUT FOR NEW FRAME
 REV D. - JCG - 2/7/2018 - ADDED DRAFT FOR CUTOUTS
 REV E. - JCG - 11/11/2020 - ADDED SECOND SHEET FOR CUTOUT DETAILS

3 OF THESE COVERS ASSEMBLE
 ONTO A 40" X 86"
 CONCAST HTFG PULL BOX

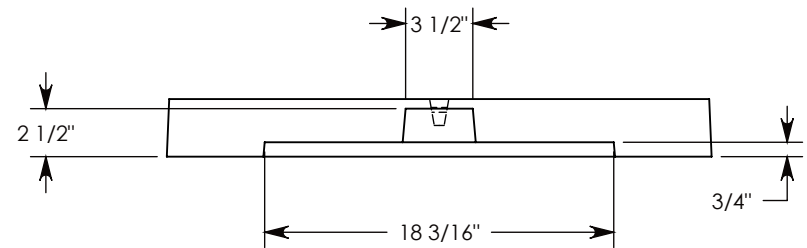
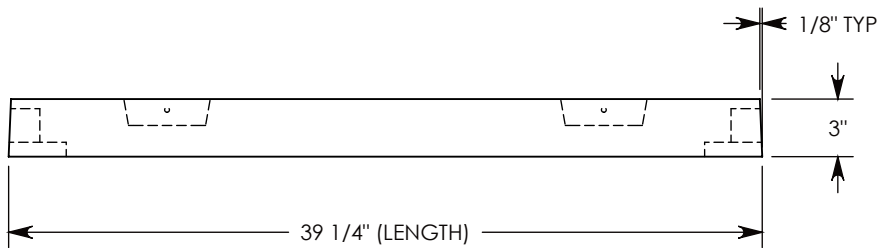
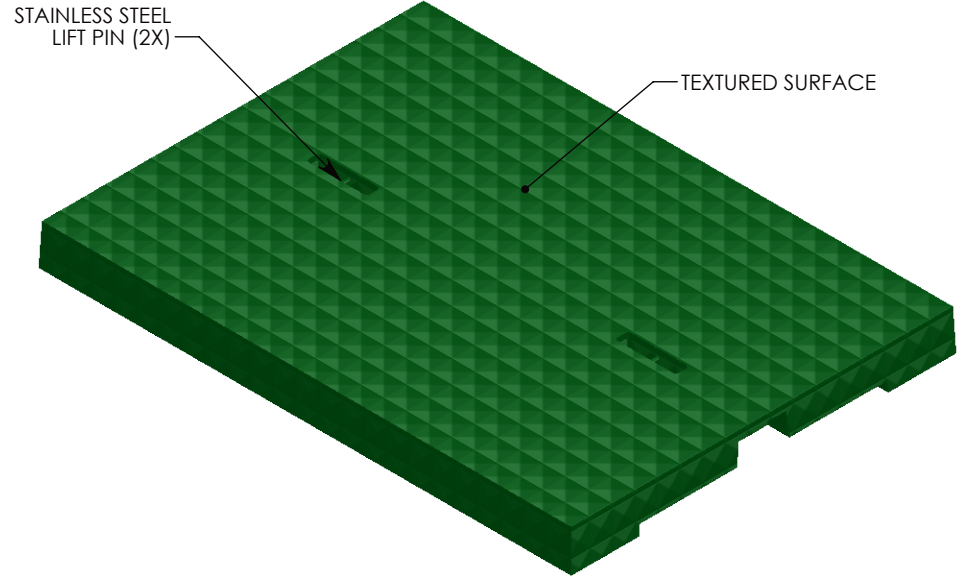
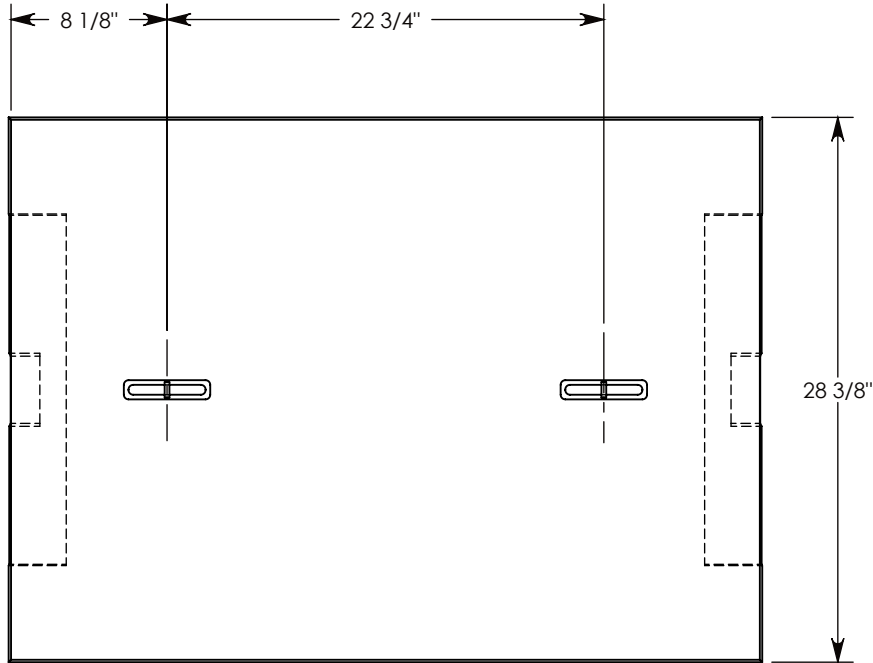

NOTE 1: GEL COAT - GREEN
NOTE 2: BOTTOM DETAIL ON SHEET 2
NOTE 3: 5° DRAFT ON ALL BOTTOM CUTOUTS

DRAWN BY: JESSE GUTTING	
CREATED DATE: 4/21/2014	REVISION LEVEL: E
SAVED DATE: 11/11/2020	SAVED BY: jgutting
WEIGHT: 85 LBS.	MATERIAL: FIBERGLASS

CONCAST
 1010 NORTH STAR DRIVE
 P.O. BOX 69
 ZUMBROTA, MN 55992-0069

DESCRIPTION: HEAVY TRAFFIC FIBERGLASS COVER		SHEET 1 OF 2
DIMENSIONS ARE IN INCHES TOLERANCES: FRACTIONAL: ± 1/8" ANGULAR: ± 2°	CONTACT INFORMATION: EMAIL: INFO@CONCASTINC.COM PHONE: (507) 732-4095 FAX: (507) 732-4094	
PART NUMBER: 40-28.7-HTFG		