

FIBERCRETE[®]
TRENCH
SYSTEM

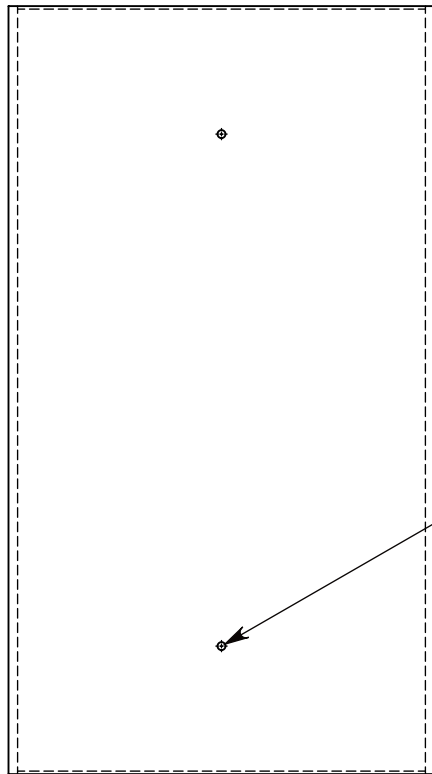

Ø 1/2"-13 UNC
 LIFTING INSERTS (2X)

STEEL REINFORCED CONCRETE

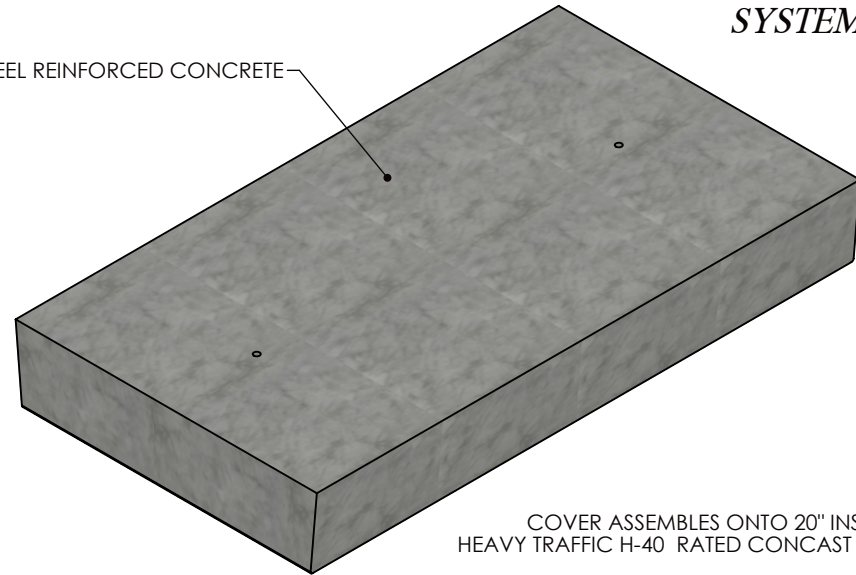

COVER ASSEMBLES ONTO 20" INSIDE WIDTH
 HEAVY TRAFFIC H-40 RATED CONCAST CHANNEL.

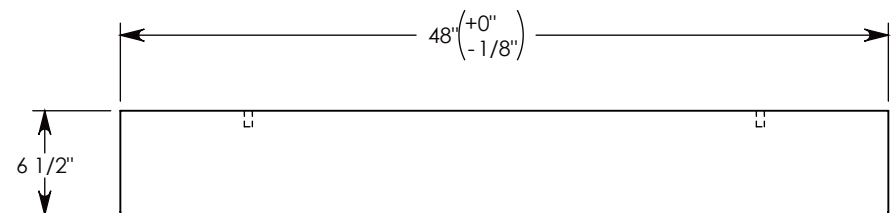
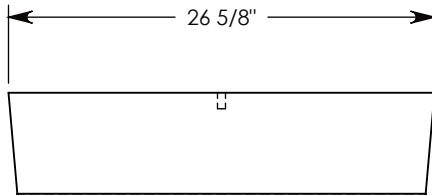

NOTE: FOR NON-STANDARD LENGTHS, THE PART NUMBER WILL
 CORRESPOND TO IT'S MEASURED LENGTH. IE: 8021HT 18"

H-40 RATED - 64,000 LB. PER AXLE LOAD.

DRAWN BY: ROBIN FLINT

DATE: 4/4/2016

REVISION LEVEL: 0

WEIGHT:

666 LBS.

MATERIAL:

CONCRETE



DESCRIPTION:

HEAVY TRAFFIC COVER

DIMENSIONS ARE IN INCHES
 TOLERANCES:
 FRACTIONAL: ± 1/8"
 ANGULAR: ± 2°

CONTACT INFORMATION:
 EMAIL: INFO@CONCASTINC.COM
 PHONE: (507) 732-4095
 FAX: (507) 732-4094

SHEET 1 OF 1

PART NUMBER:

8021HT