

QTY.	PART NUMBER
2	1-5/8" X 1-5/8" X 48" UNISTRUT
2	1-5/8" X 1-5/8" X 72" UNISTRUT
4	ULS EXTERIOR PLATE
4	ULS INTERIOR PLATE
8	1/2" CARRIAGE BOLT
8	1/2" HEX HEAD NUT

FIBERCRETE®

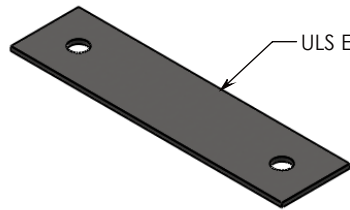

ULS EXTERIOR PLATE

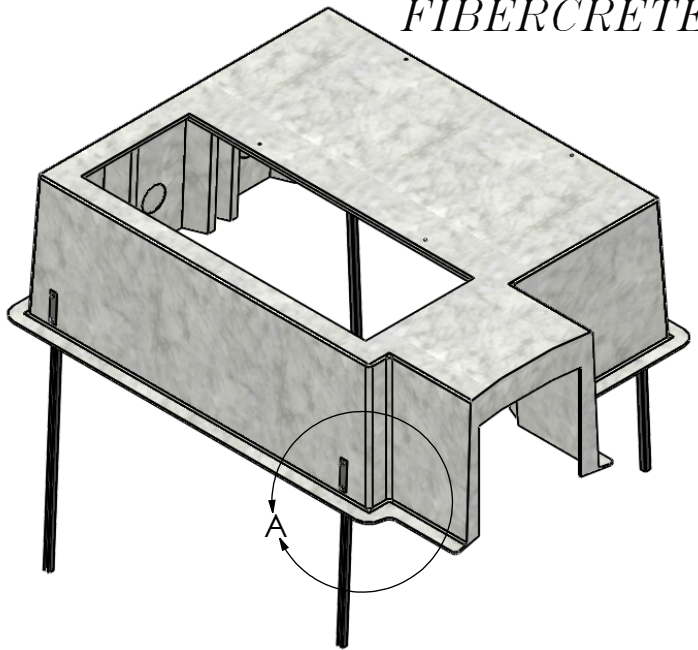
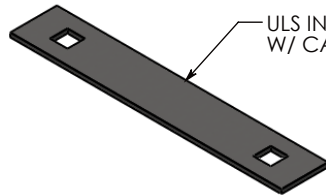

ULS INTERIOR PLATE  
W/ CARRIAGE BOLTS



48"

1-5/8" X 1-5/8" X 48" UNISTRUT\*

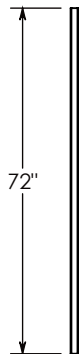

72"

1-5/8" X 1-5/8" X 72" UNISTRUT\*

1/2" HEX HEAD BOLT (2X)

ULS EXTERIOR PLATE

UNISTRUT

INSIDE SURFACE  
OF BOX PAD WALL

ULS INTERIOR PLATE  
W/ CARRIAGE BOLTS

DETAIL A

\*FIELD CUT TO LENGTH FOR  
VARYING FOUNDATION HEIGHTS.

**DRAWN BY: COLIN HORTOP**

**DATE: 11/2/2011**

**REVISION LEVEL: 0**

**WEIGHT:**

**LBS.**

**MATERIAL:**

**CONCAST**  
1010 NORTH STAR DRIVE  
P.O. BOX 69  
ZUMBROTA, MN 55992-0069

**DESCRIPTION:**

**UNISTRUT LEVELING SYSTEM**

DIMENSIONS ARE IN INCHES  
TOLERANCES:  
FRACTIONAL: ± 1/8"  
ANGULAR: ± 2°

CONTACT INFORMATION:  
EMAIL: INFO@CONCASTINC.COM  
PHONE: (507) 732-4095  
FAX: (507) 732-4094

SHEET 1 OF 1

**PART NUMBER:**

**ULS**